

HOW TO FIT?

25mm Venetian Blind

You should have:

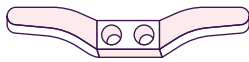

x1 Safety cleat

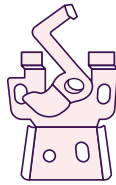

Brackets
quantity to suit length of blind



x4 Wood Screws Only

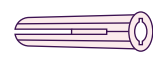

x4 Rawl Plugs

You will need:

- A drill with correct bit
- A crossheaded screwdriver
- A metal tape measure
- A pencil

Your brackets are packed separately in the box. Please ensure you've located them before disposing of the packaging. The brackets are a universal type that can be used to top fix the blind into a recess or face fix into a frame or a wall.

Please read the following instructions carefully before you start fitting your blind.

1 FIX THE BRACKETS

1. Locate the measuring points you used to calculate the width of the blind. You may be able to use the blind as a template.
2. Ensure the brackets are positioned a suitable distance away from any window handles or obstructions to allow the blind to operate smoothly.
3. Ideally, position the brackets 5cm in from each end of the head rail. Any additional brackets supplied should be fitted as centrally as possible, taking into consideration the components in the headrail.
4. Hold a bracket in position and mark where the screws will go, using the relevant holes in the bracket as a guide.
5. If you're fitting to a wall or lintel, use a drill with the suitable sized bit to make your holes, and push in wallplugs.
6. If you're fitting into a wooden frame, screw your brackets into position. You may want to make pilot holes to allow easier fixing of the screws.
7. Fix the bracket into place and repeat on the other side of the blind.

2 FIT THE BLIND

1. Open the locking arm on each bracket as far as it will go.
2. Clip the front inside edge of the head rail onto the bracket, at a slight angle away from you, and push up into place at the back.
3. Push the locking arms across into the closed position and check the blind is secure.

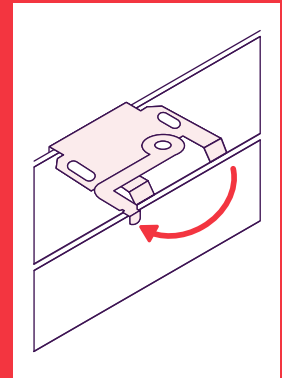
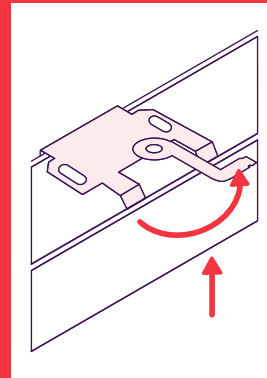

3 WARNING

Blinds can be potentially dangerous to small children. Please be aware that swallowing small parts can cause internal asphyxiation. Looped or low hanging cords, chains or tapes can create hazardous loops which could lead to the risk of strangulation. We do everything we can to ensure your chosen product is child safe. As a minimum all of our blinds meet the European Standard BS EN 13120 for safety. Our instructions and the supplied Child Safety device(s) are intended for you to ensure that your blind is as safe as possible.

The information below gives guidance for fitting the provided child safety devices. All safety devices must be correctly installed for the protection from strangulation of young children and the proper use of the blind. Please read the instructions carefully and keep safe for future reference.

Only use the devices and cords provided with your blind. Videos showing how to fit and reconnect child safety devices are available, along with replacements at www.makeitchildsafe.co.uk.

5 RE-CONNECT THE BREAKAWAY SAFETY TASSEL

Note - the safety tassel is designed to come apart to remove a hazardous loop.

Should your device become separated, any free cords should be placed into one of the holes that are formed when the two halves of the tassel are put together.

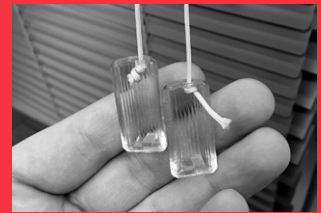
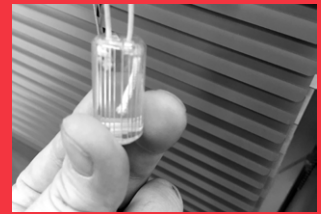

4 FITTING THE SAFETY CLEAT

Blinds that require a safety cleat must not be installed less than 1.5m from the floor. Safety cleats are designed to keep cords taut and out of reach of children – always wrap the cord around the cleat.

Fix the safety cleat to the wall with 2 screws in a position that's out of reach of children. Install it as close to the head rail as possible, ensuring that it is no closer to the floor than 1.5m.



If more than one cleat is required for the complete amount of cord to be wrapped around, ensure that they are positioned no further apart than 20cm and both are no closer to the floor than 1.5m.

Operating your blind:

- To adjust the angle of the louvres, twist the wand.
- To raise the blind, ensure the louvres are open, pull the cord down across the front of the blind until it's at the required position, and lock into place by moving the cord away from the blind.
- To lower the blind, release the cord by moving it away from the blind, then let the cord slide through your fingers.

Safety tips:

- Move beds, cots and furniture away from the window.
- Do not let cords or chains hang loose. Make sure they are kept out of reach of children at all times.
- Do not tie loose cords and chains together.
- Check the condition of all safety devices if not used regularly and replace if the device is faulty.

